

# Connection arrangements - Compact radiators, multilayer

## Connection options with x2 separating plug in the return

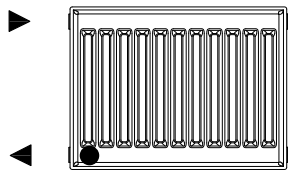

● Plug position

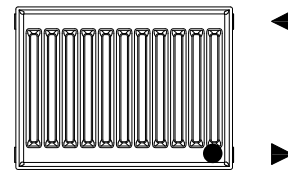

● Plug position

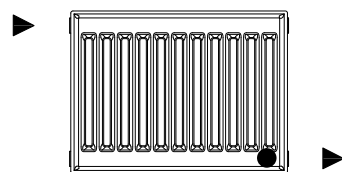

● Plug position

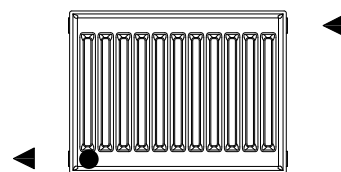

● Plug position

## Connection options without x2 separating plug

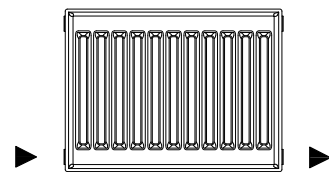

only without separating plug  
no therm-x2 effect  
**up to 8% reduced output**

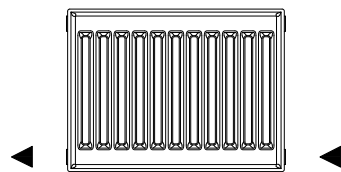

only without separating plug  
no therm-x2 effect  
**up to 8% reduced output**

## Impermissible connection types

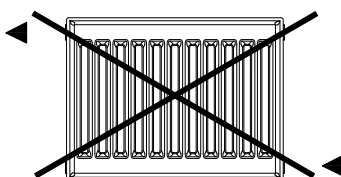
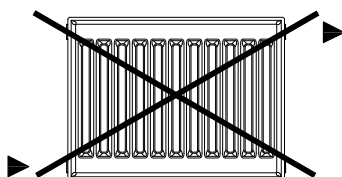
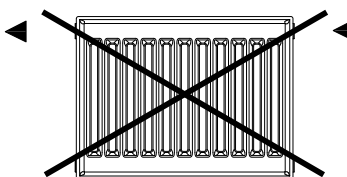
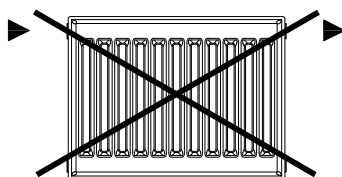

**Note:** x2 separating plug supplied with steel panel radiators. Factory-fitted in the return. (except BH 200 mm).

# Installation of therm-x2® separating plug in compact radiators

## Installation Instructions

The therm-x2 separating plug may be used only in multilayer compact radiators (Type 12, 20, 22, 30, 33) and with same-side or alternate-side connection. It is installed in the connection thread to which the return line is connected (except BH 200/205).

**Note! Use when connecting flow and return at the bottom (in-line) is not permissible.**

1. Insert assembly key in correct position and up to the stop on the separating plug.

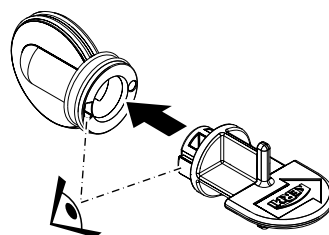

2. Observe installation position of the separating plug with assembly key:

- Horizontal grip
  - Arrow pointing towards rear/middle heating plate
- Insert separating plug into the connection thread of the radiator:**
- Gently compress the baffle
  - Push in the separating plug as far as it will go by gently moving back and forth

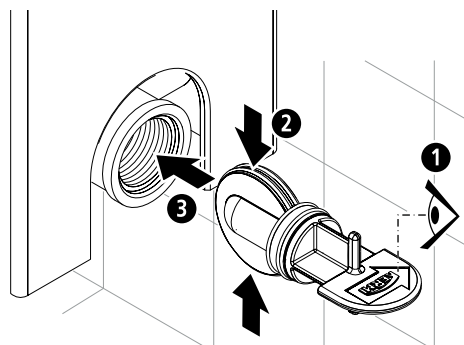

3. Check installation position of the assembly key:

- Assembly key against stop, grip horizontal
- Pull out assembly key**
- Connect radiator with suitable fittings on water side.
- Observe the max. screw-in depth into the connection thread: 14 mm.**

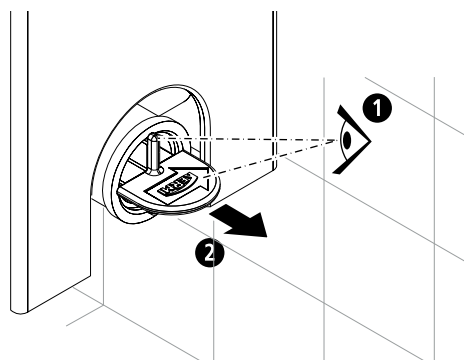

# Removal of the top grille of steel panel radiators Type 11 – 33

## Prerequisites for the removal of a top grille (side panel).

Minimum lateral distance (one side) from radiator

Radiator length	X = spacing to the wall
200	140
300	140
400	180
500	230
554	250
600	270
900	405
954	430

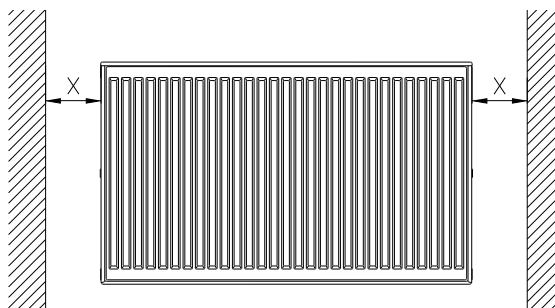

Removal of the side panel is no longer possible with angled connection (diagonal and in-line at bottom) of the radiator with fitting exiting rear wall.

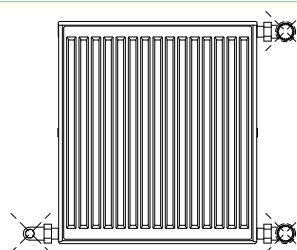

## Removal of the top grille

Lift plastic clip on side panel and unscrew anti-clockwise.  
Starting at BL 1400 for Profile radiators, remove retaining bar from top grille.

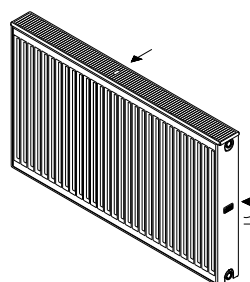

Pull side panel (slightly angled) off radiator (see illustration) and, after lifting the top grille, release from the retaining hooks.

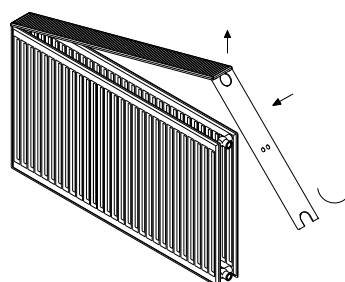

Then, separate the top grille from the second side panel by lifting and sliding it at one end.

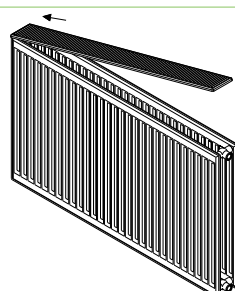

Installation of the top grille is carried out in the reverse order!

# Wall fixing

## Installation with wall bracket (long)

### 1. Description

#### Wall bracket long

Set comprising:

- 2 wall brackets,
- 2 dehinging safety devices for wall bracket,
- 3 sound insulation clips

Starting at length 1800, a 3rd bracket is needed.

Set-type	10	11 - 33
Wall spacing in mm	50	30 or 50

Suitable for requirement classes I and II.  
Fulfilled only in conjunction with  
screw set with wall anchor ZK0071 0001.



Product code	
ZB0259 0001	White, BH 300 mm
ZB0259 0002	White, BH 400 mm
ZB0259 0003	White, BH 500 mm
ZB0259 0004	White, BH 554 mm
ZB0259 0005	White, BH 600 mm
ZB0259 0006	White, BH 750 mm
ZB0259 0007	White, BH 900 mm
ZB0259 0008	White, BH 954 mm
ZB0259 0009	Zinc coated, BH 300 mm
ZB0259 0010	Zinc coated, BH 400 mm
ZB0259 0011	Zinc coated, BH 500 mm
ZB0259 0012	Zinc coated, BH 554 mm
ZB0259 0013	Zinc coated, BH 600 mm
ZB0259 0014	Zinc coated, BH 750 mm
ZB0259 0015	Zinc coated, BH 900 mm
ZB0259 0016	Zinc coated, BH 954 mm

### 2. Drill hole positioning

- Mark the drill holes (connection dimensions and lug positions, see page 73)
- Drill 2 Ø 10 mm holes
- Starting at length 1800 mm, drill additional hole in the centre
- Insert wall anchor

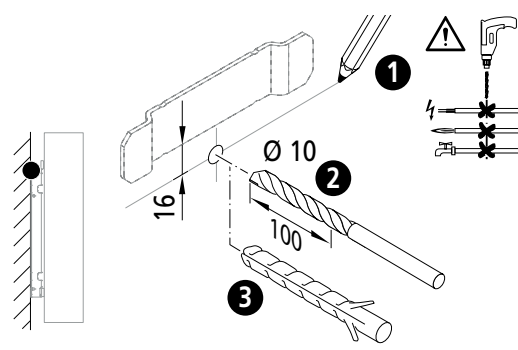

**Note!** The fixing material is designed for adequately load-bearing sub-surfaces. However, the suitable fixing method in each case must always be checked on site and the fixing material must be adjusted to the structural situation!

### 3. Wall spacing

- Selecting the distance to wall  
(30 or 50 mm)

